



VENTILATORI CENTRIFUGHI DC

DC CENTRIFUGAL FAN | VENTILATEURS CENTRIFUGES DC



INDICE Index | *Index*

VDCF 100X25 TK

VDCF 100x25 TK | *VDCF 100x25 TK*



VDCF 100X26 YC

VDCF 100x26 YC | *VDCF 100x26 YC*



Max m³/h 73,92

DC CENTRIFUGAL FAN 100x25



Sistema di supporto	Bearing System	Système de support	Ball / Sleeve
Materiale telaio	Frame material	Matériel du chassis	Thermoplastic UL94-V0
Materiale pale	Blade material	Matériel des pâles	Thermoplastic UL94-V0
Connessione	Connection	Connexion	lead wire AWG26 / 300 mm
Temperatura di lavoro	Operating temperature	Température d'utilisation	-10°C ~ + 70°C
Vita	Life	Vie	Ball 50000 h 25°C
Resistenza di isolamento	Insulation resistance	Résistance de l'isolement	10M Ω min. @500 VDC
Rigidità dielettrica	Dielectric strenght	Rigidité diélectrique	5 mA Max. at 500 VAC for 1 sec.
Protezione	Protection	Protection	IP21 (Special IP rating on request)



Codice Code Code	Tensione Voltage Tension V	Corrente Current Courant A	Potenza Power Puissance W	Velocità Speed Vitesse RPM	Portata Aria Air Flow Débit d'Air		Pressione Pressure Pression		Rumore Noise Niveau sonore dba	Peso Weight Poids g
					m ³ /h	CFM	mmH ₂ O	inchH ₂ O		
Cuscinetti a sfera Ball bearing Roulement à billes										
VDCF10025V12SMB-TK	12	0,53	6,36	4500	73,92	43,50	23,69	0,933	55,90	121,2
VDCF10025V12SLB-TK	12	0,47	5,64	4000	65,58	38,60	21,06	0,829	49,70	121,2
VDCF10025V12HB-TK	12	0,41	4,92	3500	57,42	33,80	18,42	0,725	43,50	121,2
VDCF10025V12MB-TK	12	0,35	4,20	3000	49,26	29,00	15,79	0,622	37,20	121,2
VDCF10025V12LB-TK	12	0,29	3,48	2500	40,92	24,10	13,16	0,518	31,00	121,2
VDCF10025V24SMB-TK	24	0,27	6,48	4500	73,92	43,50	23,69	0,933	55,90	121,2
VDCF10025V24SLB-TK	24	0,24	5,76	4000	65,58	38,60	21,06	0,829	49,70	121,2
VDCF10025V24HB-TK	24	0,21	5,04	3500	57,42	33,80	18,42	0,725	43,50	121,2
VDCF10025V24MB-TK	24	0,18	4,32	3000	49,26	29,00	15,79	0,622	37,20	121,2
VDCF10025V24LB-TK	24	0,15	3,60	2500	40,92	24,10	13,16	0,518	31,00	121,2

Disponibili a richiesta differenti range di temperatura di lavoro
Different working temperature ranges are available on request
Disponibles sur demande différentes plage de température

Funzioni aggiuntive / Additional Functions / Fonctions additionnelles

Serie	IR	AS	MS	FG	RD	Rdb	LD	VPWM	IPWM	PPWM	OV	TPWM	RPWM	CL	CS
VDCF	•	•		○	○	○		○	○	○					

• standard
○ su richiesta / upon request / sur demande

Portata Aria | Air Flow | Débit d'Air

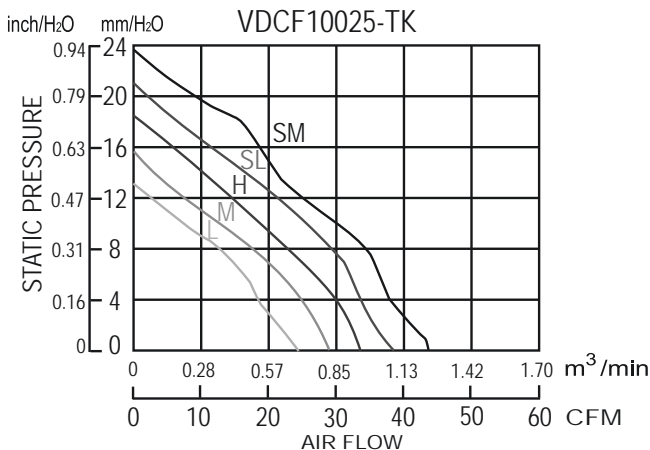

Dimensioni | Dimensions | Dimensions

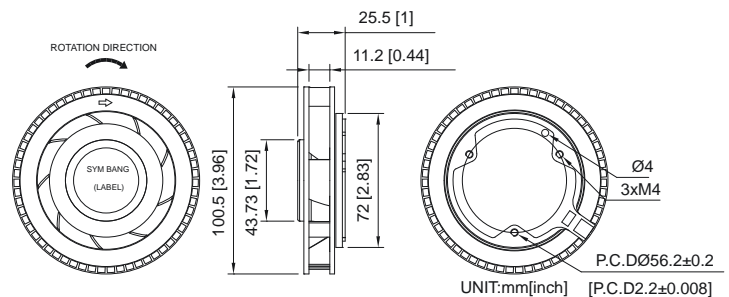

DC CENTRIFUGAL FAN 100x26

Max m³/h 85,08



Sistema di supporto	Bearing System	Système de support	Ball / Sleeve
Materiale telaio	Frame material	Matériel du chassis	Thermoplastic UL94-V0
Materiale pale	Blade material	Matériel des pâles	Fiber Glass UL94-V0
Connessione	Connection	Connexion	lead wire AWG26 / 300 mm
Temperatura di lavoro	Operating temperature	Température d'utilisation	-10°C ~ +60°C
Vita	Life	Vie	Ball 50000 h 25°C
Resistenza di isolamento	Insulation resistance	Résistance de l'isolement	10M Ω min. @500 VDC
Rigidità dielettrica	Dielectric strenght	Rigidité diélectrique	5 mA Max. at 500 VAC for 1 min.
Protezione	Protection	Protection	IP21 (Special IP rating on request)



Codice Code Code	Tensione Voltage Tension	Corrente Current Courant	Potenza Power Puissance	Velocità Speed Vitesse	Portata Aria Air Flow Débit d'Air		Pressione Pressure Pression		Rumore Noise Niveau sonore	Peso Weight Poids
	V	A	W	RPM	m ³ /h	CFM	mmH ₂ O	inchH ₂ O	dBa	g
Cuscinetti a sfera Ball bearing Roulement à billes										
VDCF10025V12H-YC	12	1,0	12,0	5000	85,08	50,09	34,23	1,35	57,42	123
VDCF10025V12M-YC	12	0,5	6,0	4000	68,46	40,32	28,70	1,13	52,40	123
VDCF10025V12L-YC	12	0,3	3,6	3000	54,72	32,24	21,85	0,86	44,53	123
VDCF10025V24H-YC	24	0,5	12,0	5000	85,08	50,09	34,23	1,35	57,42	123
VDCF10025V24M-YC	24	0,3	7,2	4000	68,46	40,32	28,70	1,13	52,40	123
VDCF10025V24L-YC	24	0,2	4,8	3000	54,72	32,24	21,85	0,86	44,53	123
VDCF10025V48H-YC	48	0,3	14,4	5000	85,08	50,09	34,23	1,35	57,42	123
VDCF10025V48M-YC	48	0,2	9,6	4000	68,46	40,32	28,70	1,13	52,40	123
VDCF10025V48L-YC	48	0,1	4,8	3000	54,72	32,24	21,85	0,86	44,53	123

Disponibili a richiesta differenti range di temperatura di lavoro
Different working temperature ranges are available on request
Disponibles sur demande différentes plage de température

Funzioni aggiuntive / Additional Functions / Fonctions additionnelles

Serie	IR	AS	MS	FG	RD	Rdb	LD	VPWM	IPWM	PPWM	OV	TPWM	RPWM	CL	CS
VDCF	●	●		○	○	○		○	○	○					

● standard
○ su richiesta / upon request / sur demande

Portata Aria | Air Flow | Débit d'Air

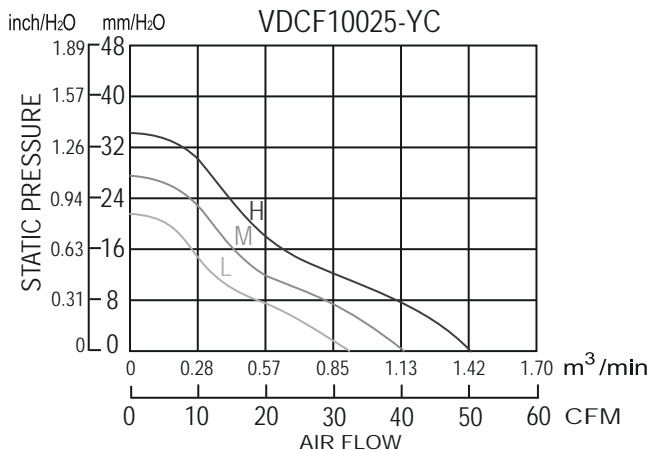

Dimensioni | Dimensions | Dimensions

